



DREHSTROM-HOCHSPANNUNGS-MOTOREN

Kühlart: IC611, Luft-Luft-Kühlung

THREE - PHASE HIGH VOLTAGE MOTORS

Cooling Method: IC611, Air-Air

MOTEURS DE HAUTE TENSION DE TROIS PHASE

Méthode de refroidissement IC611, air-air de refroidissement

6.6kV - 50 Hz - CL F - IP55



Typ	Nennleistung	Nenn-drehzahl	N-strom 6.6kV	Leistungs- faktor	Wirkungs- grad	Anzugs- moment	Anzugs- strom	Kipp- moment	Gewicht
Type	Rated output	Rated speed	Current 6.6kV	Power factor	Efficiency %	Relative torque	Relative current	B-down Torque	Weight
Type	Puissance nominale	Vitesse nominale	Intensité 6.6kV	Facteur de puissance	Rendement %	Couple démarrage	Courant démarrage	Couple maximal	Masse
	KW	1 / min	A	cos φ	%	MA / MN	Ia / In	MK / MN	kg

2 Polig / 2 Poles / 2 Pôles

HJS355A-2	220	2973	24.5	0.85	92.5	0.6	7.0	1.8	2250
HJS355B-2	250	2972	27.8	0.85	92.6	0.6	7.0	1.8	2300
HJS355C-2	280	2973	31.1	0.85	92.8	0.6	7.0	1.8	2350
HJS355D-2	315	2975	34.9	0.85	93.1	0.6	7.0	1.8	2400
HJS400B-2	355	2977	38.7	0.86	93.4	0.6	7.0	1.8	2700
HJS400C-2	400	2976	43.5	0.86	93.7	0.6	7.0	1.8	2780
HJS400D-2	450	2975	48.8	0.86	94.0	0.6	7.0	1.8	2900
HJS400E-2	500	2976	54.1	0.86	94.2	0.6	7.0	1.8	2950
HJS450B-2	560	2980	60.4	0.86	94.4	0.6	7.0	1.8	4000
HJS450C-2	630	2980	67.0	0.87	94.6	0.6	7.0	1.8	4300
HJS450D-2	710	2981	75.5	0.87	94.7	0.6	7.0	1.8	4600
HJS450E-2	800	2983	85.0	0.87	94.8	0.6	7.0	1.8	4900
HJS500A-2	900	2981	95.4	0.87	95.0	0.6	7.0	1.8	5200
HJS500B-2	1000	2983	105.9	0.87	95.1	0.6	7.0	1.8	5440
HJS500C-2	1120	2982	118.4	0.87	95.2	0.6	7.0	1.8	5650
HJS500D-2	1250	2980	132.0	0.87	95.3	0.6	7.0	1.8	5880
HJS560A-2	1400	2980	146.1	0.88	95.4	0.6	7.0	1.8	6800
HJS560B-2	1600	2979	166.7	0.88	95.5	0.6	7.0	1.8	6900
HJS560C-2	1800	2982	187.4	0.88	95.6	0.6	7.0	1.8	7160
HJS630A-2	2000	2982	208.0	0.88	95.7	0.6	7.0	1.8	9450
HJS630B-2	2240	2982	232.7	0.88	95.8	0.6	7.0	1.8	9850
HJS630C-2	2500	2982	259.4	0.88	95.9	0.6	7.0	1.8	10250
HJS710A-2	2800	2984	287.0	0.89	96.0	0.6	7.0	1.8	15250
HJS710B-2	3150	2984	322.6	0.89	96.1	0.6	7.0	1.8	15800
HJS710C-2	3550	2984	363.1	0.89	96.2	0.6	7.0	1.8	16200
HJS710D-2	4000	2984	408.7	0.89	96.3	0.6	7.0	1.8	16850
HJS800A-2	4500	2986	459.4	0.89	96.4	0.6	7.0	1.8	22300
HJS800B-2	5000	2986	509.9	0.89	96.5	0.6	7.0	1.8	23500
HJS800C-2	5600	2986	570.5	0.89	96.6	0.6	7.0	1.8	25100



DREHSTROM-HOCHSPANNUNGS-MOTOREN

Kühlart: IC611, Luft-Luft-Kühlung

THREE - PHASE HIGH VOLTAGE MOTORS

Cooling Method: IC611, Air-Air

MOTEURS DE HAUTE TENSION DE TROIS PHASE

Méthode de refroidissement IC611, air-air de refroidissement

6.6kV - 50 Hz - CL F - IP55

Typ	Nennleistung	Nenn-drehzahl	N-strom 6.6kV	Leistungs-faktor	Wirkungs-grad	Anzugs-moment	Anzugs-strom	Kipp-moment	Trägheits-moment kg m ²	Gewicht
Type	Rated output	Rated speed	Current 6.6kV	Power factor	Efficiency %	Relative torque	Relative current	B-down Torque	Moment of inertia kg m ²	Weight
Type	Puissance nominale	Vitesse nominale	Intensité 6.6kV	Facteur de puissance	Rendement %	Couple démarrage	Courant démarrage	Couple maximal	Moment d'inertie kg m ²	Masse
	kW	1/min	A	cos φ	%	Ma/Mn	Ia/In	MK/MN	Motor J Load	kg

4 Polig / 4 Poles / 4 Pôles

HJS6355A-4	185	1485	23	0.84	92.8	0.9	6.2	2.4	9	120	2400
HJS6355B-4	200	1484	24	0.85	92.9	0.9	6.1	2.4	9	130	2500
HJS6355C-4	220	1483	26	0.87	93.1	0.8	6.0	2.3	10	140	2560
HJS6355D-4	250	1484	30	0.85	93.1	0.8	6.1	2.4	10	150	2640
HJS6355E-4	280	1485	34	0.86	93.3	0.9	6.2	2.5	10	160	2700
HJS6355F-4	315	1485	38	0.85	93.6	0.9	6.3	2.6	11	170	2780
HJS6355G-4	355	1487	43	0.85	93.9	0.9	6.5	2.6	12	180	2880
HJS6400A-4	400	1484	47	0.87	93.9	0.8	6.2	2.4	19	220	3370
HJS6400B-4	450	1483	52	0.88	94.0	0.8	6.1	2.2	21	240	3510
HJS6400C-4	500	1485	58	0.88	94.2	0.9	6.2	2.3	22	255	3630
HJS6400D-4	560	1485	65	0.88	94.5	0.9	6.3	2.4	24	270	3750
HJS6450A-4	630	1487	73	0.88	94.3	0.7	6.2	2.3	26	280	4750
HJS6450B-4	710	1486	82	0.88	94.6	0.7	6.3	2.3	28	290	4880
HJS6450C-4	800	1486	92	0.88	94.9	0.7	6.2	2.3	30	300	5000
HJS6450D-4	900	1487	104	0.88	95.2	0.7	6.3	2.3	32	310	5150
HJS6500A-4	1000	1487	112	0.90	94.9	0.7	5.9	2.2	35	350	5600
HJS6500B-4	1120	1488	125	0.91	95.1	0.7	6.1	2.3	36	360	5850
HJS6500C-4	1250	1489	140	0.90	95.3	0.8	6.3	2.3	37	370	6000
HJS6500D-4	1400	1489	156	0.91	95.4	0.8	6.7	2.4	38	380	6300
HJS6560A-4	1600	1491	179	0.90	95.4	0.7	6.4	2.4	73	380	8500
HJS6560B-4	1800	1491	201	0.90	95.5	0.7	6.3	2.4	76	390	8700
HJS6560C-4	2000	1491	223	0.90	95.6	0.7	6.4	2.5	80	400	8900
HJS6630A-4	2240	1489	245	0.91	95.7	0.7	6.1	2.5	125	580	9700
HJS6630B-4	2500	1490	276	0.91	95.8	0.7	6.3	2.5	134	630	10100
HJS6630C-4	2800	1491	309	0.91	95.9	0.7	6.4	2.5	153	380	10800
HJS6630D-4	3150	1493	347	0.91	96.1	0.6	6.4	2.4	173	800	11600
HJS6710A-4	3550	1493	393	0.90	96.6	0.6	5.9	2.3	170	2010	14620
HJS6710B-4	4000	1493	442	0.90	96.7	0.6	5.8	2.3	190	2220	15340
HJS6710C-4	4500	1494	503	0.89	96.7	0.7	6.1	2.4	220	2450	15780
HJS6800A-4	5000	1494	558	0.89	96.8	0.7	5.7	2.4	270	2610	18780
HJS6800B-4	5600	1494	625	0.90	96.8	0.7	5.8	2.5	300	2820	19230
HJS6800C-4	6300	1494	697	0.90	96.9	0.7	6.0	2.5	320	2970	20140
HJS6900A-4	7100	1494	783	0.90	97.0	0.7	5.6	2.2	410	3100	24300
HJS6900B-4	8000	1494	882	0.90	97.0	0.7	5.9	2.3	450	3300	25120
HJS6900C-4	9000	1495	991	0.90	97.1	0.8	5.8	2.3	510	3410	26030
HJS61000A-4	10000	1495	1112	0.89	97.2	0.5	6.4	2.5	950	3650	32940
HJS61000B-4	11200	1495	1246	0.89	97.2	0.6	6.9	2.7	980	3850	33870
HJS61000C-4	12500	1494	1389	0.89	97.3	0.5	5.7	2.2	1080	4090	34570
HJS61000D-4	14000	1495	1554	0.90	97.3	0.6	6.0	2.3	1180	4270	35320
HJS61000E-4	16000	1495	1756	0.90	97.4	0.6	6.5	2.5	1240	4480	36900





DREHSTROM-HOCHSPANNUNGS-MOTOREN

Kühlart: IC611, Luft-Luft-Kühlung

THREE - PHASE HIGH VOLTAGE MOTORS

Cooling Method: IC611, Air-Air

MOTEURS DE HAUTE TENSION DE TROIS PHASE

Méthode de refroidissement IC611, air-air de refroidissement



6.6kV - 50 Hz - CL F - IP55

Typ	Nennleistung	Nenn-drehzahl	N-strom 6.6kV	Leistungs-faktor	Wirkungs-grad	Anzugs-moment	Anzugs-strom	Kipp-moment	Trägheits-moment kg m2	Gewicht	
Type	Rated output	Rated speed	Current 6.6kV	Power factor	Efficiency %	Relative torque	Relative current	B-down Torque	Moment of inertia kg m2	Weight	
Type	Puissance nominale	Vitesse nominale	Intensité 6.6kV	Facteur de puissance	Rendement %	Couple démarrage	Courant démarrage	Couple maximal	Moment d'inertie kg m2	Masse	
	KW	1 / min	A	cos φ	%	MA / MN	Ia / In	MK / MN	Motor J Load	kg	
6 Polig / 6 Poles / 6 Pôles											
HJS6355A-6	185	984	24	0.81	92.2	1.1	5.5	2.3	15	320	2550
HJS6355B-6	200	985	25	0.82	92.5	1.1	5.6	2.3	16	330	2650
HJS6355C-6	220	986	28	0.82	92.7	1.1	5.7	2.3	17	340	2720
HJS6355D-6	250	986	30	0.81	92.7	1.2	5.9	2.4	18	350	2800
HJS6400A-6	280	985	34	0.86	93.1	0.9	5.6	2.0	18	400	3350
HJS6400B-6	315	986	38	0.86	93.4	0.9	5.5	2.0	19	420	3490
HJS6400C-6	355	986	43	0.86	93.7	0.9	5.4	2.0	20	440	3620
HJS6400D-6	400	987	48	0.85	93.9	0.9	5.5	2.0	21	460	3750
HJS6450A-6	450	988	53	0.88	94.1	0.8	5.5	2.0	35	580	4880
HJS6450B-6	500	988	59	0.87	94.4	0.8	5.6	2.0	37	600	4800
HJS6450C-6	560	988	66	0.87	94.7	0.8	5.6	2.0	40	620	4920
HJS6450D-6	630	988	74	0.87	94.9	0.9	5.8	2.0	42	667	5150
HJS6500A-6	710	991	83	0.87	94.8	0.8	5.9	2.2	43	705	5600
HJS6500B-6	800	991	94	0.87	94.9	0.9	5.9	2.2	45	720	5750
HJS6500C-6	900	991	104	0.87	95.0	0.9	6.0	2.3	52	770	6000
HJS6500D-6	1000	991	116	0.88	95.1	0.9	6.4	2.3	55	800	6250
HJS6560A-6	1120	992	131	0.87	95.2	0.7	5.8	2.3	94	1050	7800
HJS6560B-6	1250	991	145	0.87	95.3	0.7	5.9	2.4	110	1150	8100
HJS6560C-6	1400	992	163	0.87	95.4	0.8	6.4	2.5	125	1248	8300
HJS6630A-6	1600	993	185	0.87	95.6	0.7	6.1	2.3	171	1400	9450
HJS6630B-6	1800	993	208	0.87	95.7	0.7	6.2	2.2	199	1500	9800
HJS6630C-6	2000	993	231	0.87	95.9	0.8	6.2	2.2	213	1600	10200
HJS6630D-6	2240	993	258	0.87	96.1	0.7	5.9	2.1	242	1750	11000
HJS6710A-6	2500	992	286	0.87	96.5	0.8	6.2	2.5	230	2720	13420
HJS6710B-6	2800	992	321	0.87	96.5	0.8	6.3	2.6	260	2870	13980
HJS6710C-6	3150	992	361	0.87	96.6	0.8	6.4	2.7	280	3010	14560
HJS6710D-6	3550	992	406	0.87	96.7	0.8	6.3	2.6	305	3280	15300
HJS6800A-6	4000	993	457	0.87	96.7	0.7	6.5	2.3	360	3780	18390
HJS6800B-6	4500	993	514	0.87	96.7	0.7	6.4	2.3	380	4140	18870
HJS6800C-6	5000	993	571	0.87	96.8	0.8	6.5	2.4	430	4480	19500
HJS6900A-6	5600	993	639	0.88	96.9	0.7	6.0	2.5	560	5200	24150
HJS6900B-6	6300	995	710	0.88	97.0	0.8	6.5	2.7	630	5880	25030
HJS6900C-6	7100	995	800	0.89	97.0	0.9	6.2	2.6	665	6140	25980
HJS61000A-6	8000	996	890	0.89	97.2	0.7	6.0	2.4	1180	6270	32130
HJS61000B-6	9000	996	1001	0.89	97.2	0.7	6.0	2.4	1280	6740	32980
HJS61000C-6	10000	996	1111	0.89	97.3	0.7	6.1	2.4	1420	7260	33990
HJS61000D-6	11200	996	1244	0.90	97.3	0.8	6.3	2.4	1570	8220	35450





DREHSTROM-HOCHSPANNUNGS-MOTOREN

Kühlart: IC611, Luft-Luft-Kühlung

THREE - PHASE HIGH VOLTAGE MOTORS

Cooling Method: IC611, Air-Air

MOTEURS DE HAUTE TENSION DE TROIS PHASE

Méthode de refroidissement IC611, air-air de refroidissement

6.6kV - 50 Hz - CL F - IP55



Typ	Nennleistung	Nenn-drehzahl	N-strom 6.6kV	Leistungs-faktor	Wirkungs-grad	Anzugs-moment	Anzugs-strom	Kipp-moment	Trägheits-moment kg m2	Gewicht	
Type	Rated output	Rated speed	Current 6.6kV	Power factor	Efficiency %	Relative torque	Relative current	B-down Torque	Moment of inertia kg m2	Weight	
Type	Puissance nominale	Vitesse nominale	Intensité 6.6kV	Facteur de puissance	Rendement %	Couple démarrage	Courant démarrage	Couple maximal	Moment d'inertie kg m2	Masse	
	KW	1 / min	A	cos φ	%	MA / MN	Ia / In	MK / MN	Motor J Load	kg	
8 Polig / 8 Poles / 8 Pôles											
HJS6400A-8	185	739	24	0.79	92.6	1.2	6.0	2.2	22	600	3250
HJS6400B-8	200	738	26	0.80	92.5	1.3	5.8	2.3	23	620	3350
HJS6400C-8	220	739	30	0.77	92.5	1.3	5.7	2.3	24	640	3400
HJS6400D-8	250	738	33	0.79	92.8	1.2	5.6	2.2	26	660	3550
HJS6400E-8	280	738	36	0.80	93.1	1.1	5.5	2.2	26	680	3650
HJS6400F-8	315	738	40	0.81	93.5	1.1	5.4	2.1	27	700	3750
HJS6450A-8	355	741	43	0.80	93.5	0.8	5.6	2.3	37	900	4780
HJS6450B-8	400	741	48	0.81	93.6	0.8	5.5	2.3	38	1000	4860
HJS6450C-8	450	744	54	0.82	94.1	0.8	5.5	2.1	39	1100	4950
HJS6450D-8	500	744	60	0.81	94.2	0.9	5.5	2.1	40	1200	5000
HJS6500A-8	560	740	66	0.86	94.4	1.0	5.5	2.1	55	1500	5550
HJS6500B-8	630	740	74	0.86	94.6	0.9	5.5	2.1	60	1600	5700
HJS6500C-8	710	740	84	0.86	94.8	1.0	5.9	2.1	68	1800	6000
HJS6500D-8	800	740	93	0.87	95.0	0.9	5.4	2.1	75	1950	6300
HJS6560A-8	900	742	107	0.85	94.9	1.0	5.8	2.3	121	2000	7800
HJS6560B-8	1000	743	119	0.85	95.0	1.0	5.9	2.4	130	2100	8000
HJS6560C-8	1120	742	133	0.85	95.2	0.9	5.7	2.3	139	2300	8200
HJS6630A-8	1250	743	148	0.86	95.3	0.7	5.4	2.1	224	2300	9200
HJS6630B-8	1400	743	164	0.86	95.4	0.8	5.6	2.2	242	2500	9550
HJS6630C-8	1600	743	187	0.86	95.5	0.7	5.6	2.2	259	2800	10000
HJS6630D-8	1800	744	213	0.85	95.6	0.7	5.7	2.1	293	3000	10800
HJS6710A-8	2000	745	245	0.82	95.9	0.7	5.8	2.4	265	5420	13620
HJS6710B-8	2240	745	274	0.82	96.0	0.7	5.7	2.3	300	5990	14370
HJS6710C-8	2500	746	305	0.82	96.0	0.7	5.7	2.3	330	6580	15180
HJS6800A-8	2800	745	334	0.84	96.1	0.7	5.8	2.4	390	7200	18240
HJS6800B-8	3150	745	375	0.84	96.2	0.7	5.9	2.5	440	7910	18650
HJS6800C-8	3550	745	423	0.84	96.2	0.8	5.6	2.4	480	8960	19370
HJS6900A-8	4000	745	465	0.86	96.3	0.9	5.7	2.3	670	9470	24020
HJS6900B-8	4500	745	529	0.85	96.3	0.9	5.7	2.4	740	10230	24830
HJS6900C-8	5000	745	580	0.86	96.4	0.9	5.9	2.4	800	11020	25880
HJS61000A-8	5600	746	642	0.87	96.4	0.9	5.9	2.6	1140	11080	31670
HJS61000B-8	6300	746	723	0.87	96.4	0.9	6.1	2.5	1300	12160	32470
HJS61000C-8	7100	746	814	0.87	96.5	0.9	6.0	2.6	1380	13300	33240
HJS61000D-8	8000	746	916	0.87	96.6	0.9	6.2	2.7	1540	15390	34650
HJS61000E-8	9000	746	1030	0.87	96.6	0.9	5.9	2.8	1660	16500	36070
HJS61120A-8	10000	747	1130	0.88	96.8	0.9	5.7	2.6	2170	17030	38900
HJS61120B-8	11200	747	1264	0.88	96.9	0.8	5.6	2.5	2300	17290	40110
HJS61120C-8	12500	747	1410	0.88	96.9	0.9	5.6	2.6	2480	18390	41200
HJS61120D-8	14000	747	1579	0.88	97.0	0.9	5.8	2.7	2670	20090	42760





DREHSTROM-HOCHSPANNUNGS-MOTOREN

Kühlart: IC611, Luft-Luft-Kühlung

THREE - PHASE HIGH VOLTAGE MOTORS

Cooling Method: IC611, Air-Air

MOTEURS DE HAUTE TENSION DE TROIS PHASE

Méthode de refroidissement IC611, air-air de refroidissement



6.6kV - 50 Hz - CL F - IP55

Type	Nennleistung	Nenn-drehzahl	N-strom 6.6kV	Leistungs-faktor	Wirkungs-grad	Anzugs-moment	Anzugs-strom	Kipp-moment	Trägheits-moment kg m2	Gewicht
Type	Rated output	Rated speed	Current 6.6kV	Power factor	Efficiency %	Relative torque	Relative current	B-down Torque	Moment of inertia kg m2	Weight
Type	Puissance nominale	Vitesse nominale	Intensité 6.6kV	Facteur de puissance	Rendement %	Couple démarrage	Courant démarrage	Couple maximal	Moment d'inertie kg m2	Masse

	KW	1 / min	A	cos φ	%	MA / MN	Ia / In	MK / MN	Motor	J Load	kg
--	----	---------	---	-------	---	---------	---------	---------	-------	--------	----

10 Polig / 10 Poles / 10 Pôles

HJS6400A-10	185	587	25	0.77	91.3	0.7	5.5	1.8	26	750	4700
HJS6400B-10	200	588	28	0.76	91.5	0.8	5.5	1.8	28	800	4800
HJS6400C-10	220	588	30	0.76	91.9	0.8	5.5	1.8	30	900	4900
HJS6450A-10	250	590	33	0.80	92.2	0.9	5.4	2.4	42	1000	4550
HJS6450B-10	280	590	36	0.81	92.5	0.8	5.5	2.3	44	1100	4650
HJS6450C-10	315	590	40	0.81	92.7	0.8	5.4	2.3	46	1200	4750
HJS6450D-10	355	590	45	0.81	93.0	1.1	5.0	2.3	48	1300	4850
HJS6500A-10	400	592	52	0.79	93.5	1.1	5.3	2.2	56	2272	5520
HJS6500B-10	450	592	59	0.79	93.5	1.0	5.1	2.1	60	2532	5730
HJS6500C-10	500	593	65	0.79	93.8	1.0	5.3	2.2	71	2839	6000
HJS6500D-10	560	593	73	0.79	93.9	1.0	5.3	2.2	76	3034	6200
HJS6500E-10	630	592	80	0.81	94.1	0.9	5.1	2.1	89	3120	6400
HJS6560A-10	710	592	86	0.84	94.2	1.0	5.3	2.3	117	3200	7600
HJS6560B-10	800	592	96	0.85	94.4	1.1	5.4	2.3	137	3400	8000
HJS6560C-10	900	592	109	0.84	94.6	1.0	5.4	2.3	146	3500	8200
HJS6560D-10	1000	592	120	0.85	94.8	1.0	5.3	2.2	165	3600	8400
HJS6630A-10	1120	593	135	0.84	94.8	1.0	5.6	2.1	269	4000	9100
HJS6630B-10	1250	592	151	0.84	94.9	0.9	5.6	2.1	312	4300	9500
HJS6630C-10	1400	593	168	0.84	95.1	1.0	5.8	2.1	353	4600	10100
HJS6630D-10	1600	593	193	0.84	95.2	0.9	5.6	2.2	368	6000	10700
HJS6710A-10	1600	595	201	0.80	95.5	0.8	5.3	2.4	315	6350	13450
HJS6710B-10	1800	595	227	0.81	95.5	0.8	5.5	2.3	350	7230	13980
HJS6710C-10	2000	595	249	0.81	95.6	0.8	5.6	2.4	390	8010	14530
HJS6710D-10	2240	595	275	0.82	95.6	0.7	5.0	2.2	450	9770	15140
HJS6800A-10	2500	595	308	0.82	95.7	0.8	5.2	2.3	530	11140	17990
HJS6800B-10	2800	596	347	0.81	95.8	0.8	5.6	2.5	600	13080	18740
HJS6900A-10	3150	595	385	0.82	95.9	0.7	4.6	2.0	660	13290	23580
HJS6900B-10	3550	595	433	0.82	96.1	0.8	4.9	2.1	750	14210	24370
HJS6900C-10	4000	595	488	0.82	96.2	0.8	5.2	2.2	840	15840	25610
HJS61000A-10	4500	595	548	0.83	96.4	0.7	4.7	2.0	840	16800	30800
HJS61000B-10	5000	596	600	0.83	96.5	0.6	5.2	2.3	1510	18120	31740
HJS61000C-10	5600	596	664	0.84	96.6	0.6	5.2	2.3	1700	19550	32680
HJS61000D-10	6300	596	755	0.83	96.7	0.6	5.3	2.2	1750	21630	33810
HJS61120A-10	7100	596	840	0.84	96.8	0.6	5.3	2.3	1880	22600	38100
HJS61120B-10	8000	596	934	0.85	96.9	0.5	4.6	2.4	2200	23080	39040
HJS61120C-10	9000	596	1050	0.85	97.0	0.6	4.7	2.2	2460	24680	40120
HJS61120D-10	10000	596	1167	0.84	97.1	0.6	5.0	2.4	2730	27570	41410





DREHSTROM-HOCHSPANNUNGS-MOTOREN

Kühlart: IC611, Luft-Luft-Kühlung

THREE - PHASE HIGH VOLTAGE MOTORS

Cooling Method: IC611, Air-Air

MOTEURS DE HAUTE TENSION DE TROIS PHASE

Méthode de refroidissement IC611, air-air de refroidissement

6.6kV - 50 Hz - CL F - IP55



Typ	Nennleistung	Nenn-drehzahl	N-strom 6.6kV	Leistungs-faktor	Wirkungs-grad	Anzugs-moment	Anzugs-strom	Kipp-moment	Trägheits-moment kg m2	Gewicht
Type	Rated output	Rated speed	Current 6.6kV	Power factor	Efficiency %	Relative torque	Relative current	B-down Torque	Moment of inertia kg m2	Weight
Type	Puissance nominale	Vitesse nominale	Intensité 6.6kV	Facteur de puissance	Rendement %	Couple démarrage	Courant démarrage	Couple maximal	Moment d'inertie kg m2	Masse

	KW	1 / min	A	cos φ	%	MA / MN	Ia / In	MK / MN	Motor	J Load	kg
--	----	---------	---	-------	---	---------	---------	---------	-------	--------	----

12 Polig / 12 Poles / 12 Pôles

HJS6450A-12	185	489	27	0.73	91.5	0.9	5.0	2.1	42	1400	4600
HJS6450B-12	200	490	29	0.73	91.7	0.9	5.1	2.1	44	1500	4700
HJS6450C-12	220	490	32	0.73	92.2	0.9	4.7	2.1	46	1600	4800
HJS6450D-12	250	491	36	0.72	92.6	0.9	5.3	2.1	48	1700	4900
HJS6500A-12	280	492	38	0.77	93.1	1.1	4.9	2.2	55	2900	5500
HJS6500B-12	315	492	42	0.77	93.3	1.1	4.8	2.2	60	3060	5620
HJS6500C-12	355	493	48	0.77	93.4	1.1	4.9	2.2	65	3225	5800
HJS6500D-12	400	493	53	0.78	93.6	1.1	4.9	2.2	77	3345	6000
HJS6500E-12	450	493	59	0.78	93.7	1.1	5.1	2.3	85	3580	6200
HJS6560A-12	500	494	65	0.79	94.1	1.1	5.5	2.4	140	3600	7130
HJS6560B-12	560	494	74	0.78	94.3	1.2	5.7	2.5	164	3700	7630
HJS6560C-12	630	494	80	0.80	94.5	1.0	5.2	2.3	185	3800	9630
HJS6560D-12	710	493	92	0.78	94.6	1.0	5.3	2.4	196	3900	9770
HJS6630A-12	800	495	100	0.81	94.7	0.8	5.2	2.0	315	4900	9100
HJS6630B-12	900	495	111	0.82	94.8	0.8	5.3	2	345	5400	9400
HJS6630C-12	1000	495	125	0.81	95.0	0.9	5.1	2.1	360	5800	9800
HJS6630D-12	1120	495	138	0.82	95.1	0.9	5.2	2.2	378	6600	10400
HJS6710A-12	1250	495	162	0.78	95.2	0.9	5.7	2.6	290	9850	13220
HJS6710B-12	1400	495	181	0.78	95.2	0.9	5.7	2.5	300	10750	13720
HJS6710C-12	1600	495	205	0.79	95.2	0.9	5.5	2.6	300	11080	14170
HJS6800A-12	1800	496	227	0.80	95.4	1.0	5.7	2.5	560	12030	17640
HJS6800B-12	2000	496	249	0.81	95.5	1.0	5.8	2.6	600	12240	18130
HJS6800C-12	2240	496	279	0.81	95.5	1.0	5.8	2.6	660	13350	18740
HJS6900A-12	2500	495	307	0.82	95.6	0.9	5.7	2.6	890	14000	23310
HJS6900B-12	2800	496	333	0.82	95.7	0.9	5.9	2.6	970	14570	24120
HJS6900C-12	3150	496	386	0.83	95.7	1.0	6.0	2.7	1090	15500	25040
HJS61000A-12	3550	496	429	0.83	95.9	0.9	5.7	2.4	1570	24440	29520
HJS61000B-12	4000	496	483	0.82	96.0	0.8	5.5	2.3	1720	26270	30400
HJS61000C-12	4500	496	543	0.83	96.0	0.8	5.4	2.3	1870	28150	31530
HJS61000D-12	5000	496	603	0.83	96.1	0.9	5.5	2.3	1980	30970	32970
HJS61120A-12	5600	496	667	0.84	96.2	0.7	5.2	2.3	2400	32030	37470
HJS61120B-12	6300	496	740	0.85	96.2	0.7	5.2	2.2	2620	33530	38330
HJS61120C-12	7100	496	835	0.85	96.3	0.7	5.3	2.3	2840	36030	39240
HJS61120D-12	8000	497	951	0.84	96.4	0.7	5.4	2.3	3130	38670	40840





DREHSTROM-HOCHSPANNUNGS-MOTOREN

Kühlart: IC611, Luft-Luft-Kühlung

THREE - PHASE HIGH VOLTAGE MOTORS

Cooling Method: IC611, Air-Air

MOTEURS DE HAUTE TENSION DE TROIS PHASE

Méthode de refroidissement IC611, air-air de refroidissement

6.6kV - 50 Hz - CL F - IP55



Typ	Nennleistung	Nenn-drehzahl	N-strom 6.6kV	Leistungs-faktor	Wirkungs-grad	Anzugs-moment	Anzugs-strom	Kipp-moment	Trägheits-moment kg m2	Gewicht
Type	Rated output	Rated speed	Current 6.6kV	Power factor	Efficiency %	Relative torque	Relative current	B-down Torque	Moment of inertia kg m2	Weight
Type	Puissance nominale	Vitesse nominale	Intensité 6.6kV	Facteur de puissance	Rendement %	Couple démarrage	Courant démarrage	Couple maximal	Moment d'inertie kg m2	Masse
	KW	1 / min	A	cos φ	%	MA / MN	Ia / In	MK / MN	Motor J Load	kg

16 Polig / 16 Poles / 16 Pôles

HJS6710A-16	710	370	99	0.74	93.5	0.9	5.3	2.5	300	11620	12780
HJS6710B-16	800	370	110	0.75	93.5	0.9	5.4	2.6	340	12260	13100
HJS6710C-16	900	370	125	0.74	93.6	0.9	5.4	2.6	380	13540	13580
HJS6710D-16	1000	370	137	0.75	93.6	0.9	5.5	2.6	450	14910	14010
HJS6800A-16	1120	370	154	0.74	94.3	0.8	5.3	2.2	510	18260	17820
HJS6800B-16	1250	370	172	0.74	94.4	0.8	5.4	2.2	570	20100	18310
HJS6800C-16	1400	370	195	0.73	94.5	0.8	5.6	2.4	640	22810	18630
HJS6900A-16	1600	371	219	0.74	94.8	0.8	5.6	2.4	890	19300	22720
HJS6900B-16	1800	371	247	0.74	94.8	0.8	5.7	2.3	990	20780	23360
HJS6900C-16	2000	371	274	0.74	94.9	0.8	5.7	2.3	1050	22350	24030
HJS6900D-16	2240	371	303	0.75	94.9	0.8	5.8	2.3	1140	24670	25160
HJS61000A-16	2500	371	333	0.76	95.0	0.9	5.8	2.2	1541	35930	28680
HJS61000B-16	2800	371	368	0.77	95.0	0.9	5.9	2.2	1650	38970	29670
HJS61000C-16	3150	371	414	0.77	95.1	0.9	5.8	2.1	1850	42450	31410
HJS61000D-16	3550	372	473	0.76	95.1	0.9	5.9	2.2	2060	46080	32100
HJS61120A-16	4000	372	515	0.78	95.8	0.8	5.8	2.1	2310	52400	35120
HJS61120B-16	4500	372	579	0.78	95.8	0.8	5.9	2.2	2520	57500	36600
HJS61120C-16	5000	372	635	0.79	95.9	0.9	5.7	2.3	2820	61550	38110
HJS61120D-16	5600	372	711	0.79	96.0	0.9	5.9	2.2	3040	72630	39750



Overall mounting dimensions for HJS (6.6kV / 11kV) series of high-voltage three-phase induction motors.

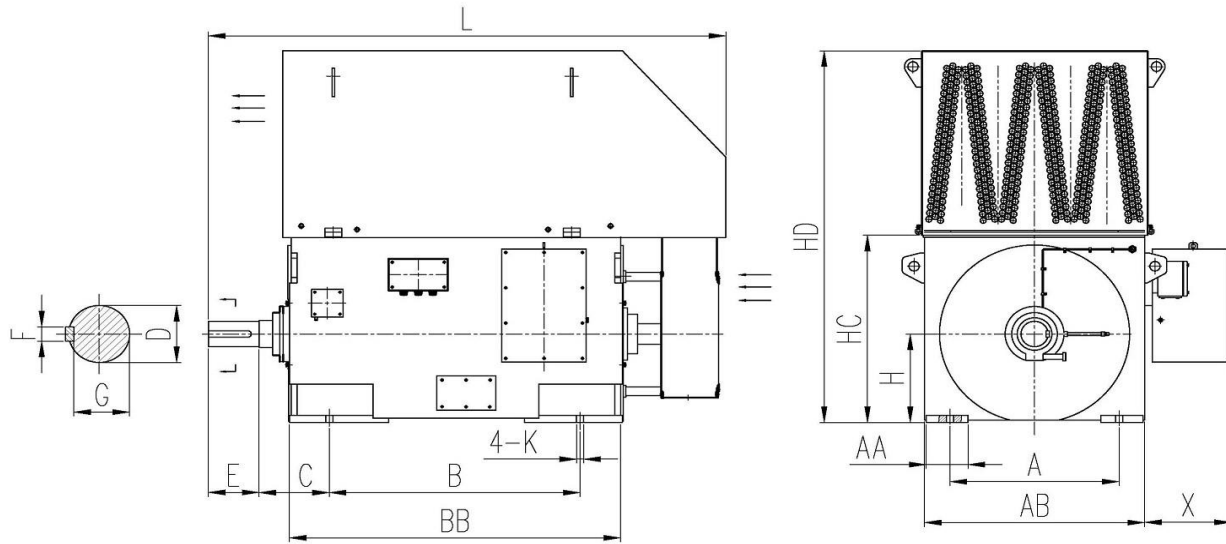

Frame	A	AA	AB	B	BB	C	D	E	F	G	H	HC	HD	K	L	X
HJS355 2	630	160	800	900	1420	315	80	170	22	71	355	755	1250	28	2200	510
HJS355 4-8	630	160	800	900	1420	315	100	210	28	90	355	755	1250	28	2200	510
HJS400 2	710	170	900	1000	1570	335	90	170	25	81	400	850	1350	35	2400	510
HJS400 4-8	710	170	900	1000	1570	335	110	210	28	100	400	850	1350	35	2400	510
HJS450 2	800	190	1000	1120	1720	355	100	210	28	90	450	950	1550	35	2600	510
HJS450 4	800	190	1000	1120	1720	355	120	210	32	109	450	950	1550	35	2600	510
HJS450 6-12	800	190	1000	1120	1720	355	130	250	32	119	450	950	1550	35	2600	510
HJS500 2	900	200	1120	1250	1820	475	110	210	28	100	500	1060	1700	42	2900	510
HJS500 4	900	200	1120	1250	1820	475	130	250	32	119	500	1060	1700	42	2900	510
HJS500 6-12	900	200	1120	1250	1820	475	140	250	36	128	500	1060	1700	42	2900	510
HJS560 2	1000	230	1250	1400	1970	500	130	250	32	119	560	1185	1850	42	3200	560
HJS560 4	1000	230	1250	1400	1970	500	150	250	36	138	560	1185	1850	42	3200	560
HJS560 6-12	1000	230	1250	1400	1970	500	160	300	40	147	560	1185	1850	42	3200	560
HJS630 2	1120	240	1400	1600	2120	530	140	250	36	128	630	1330	2700	48	3500	560
HJS630 4	1120	240	1400	1600	2120	530	170	300	40	157	630	1330	2700	48	3500	560
HJS630 6-12	1120	240	1400	1600	2120	530	180	300	45	165	630	1330	2700	48	3500	560

Overall mounting dimensions for HJS (6.6kV / 11kV) series of high-voltage three-phase induction motors.

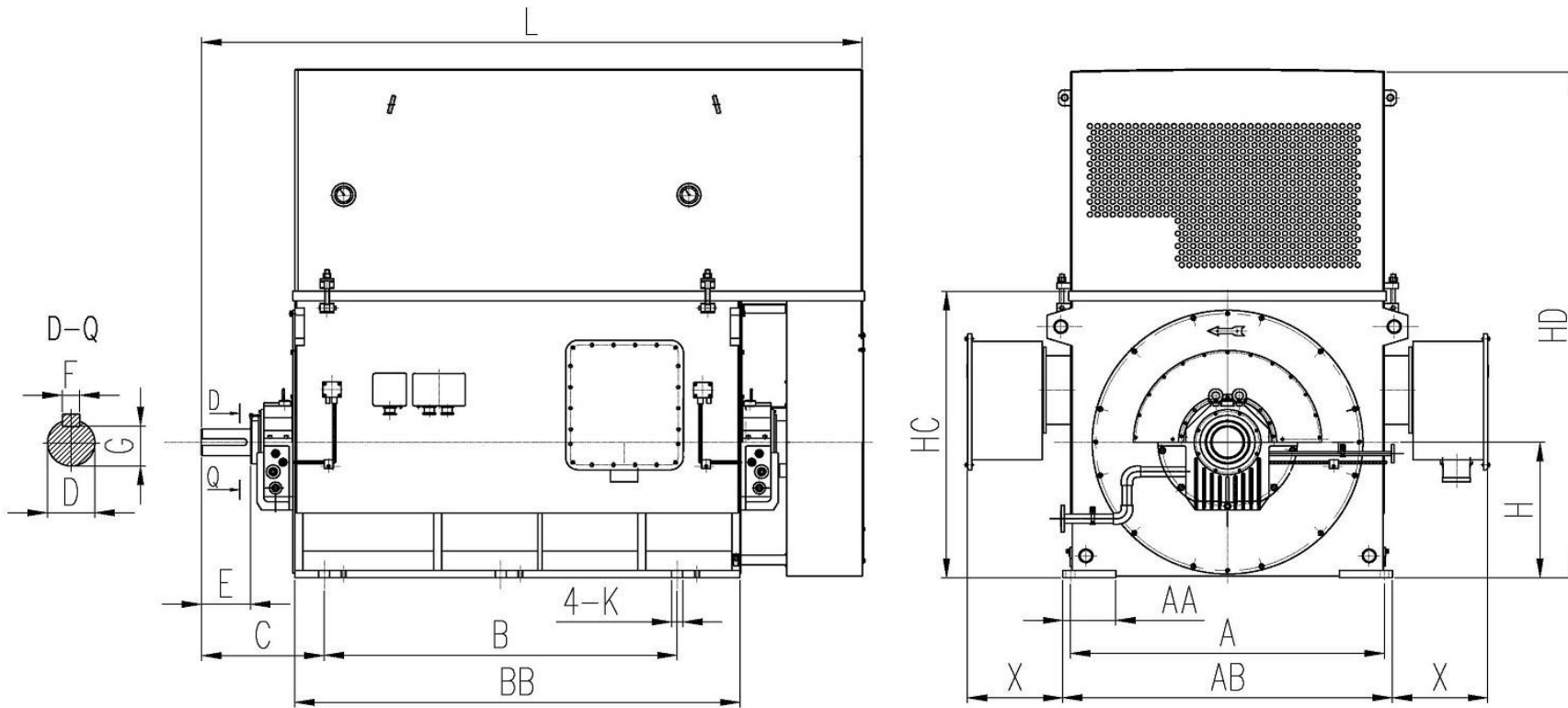

Frame	A	B	C	AB	AA	BB	D	E	F	G	H	K	HC	HD	L	X
HJS710 2-16	1400	1800	530	1600	262	2150/2330	200	350	45	185	710	56	1510	2960	3850	600
HJS800 2-16	1600	2000	560	1800	292	2350/2500	220	350	50	203	800	56	1700	3175	4050	600
HJS900 2-16	1800	2000/2200	560	2000	302	2500/2700	250	410	56	230	900	66	1900	3420	4500	600
HJS1000 2-16	2000	2000/2200	630	2240	332	2500/2900	280	470	63	260	1000	66	2120	3720	4550	600
HJS1120 2-16	2240	2200/2500	630	2500	402	2700/3200	320	470	70	298	1120	74	2370	4190	4800	600